

LIFTERS

Electric lifter

HES-G

Gemini –
stationary

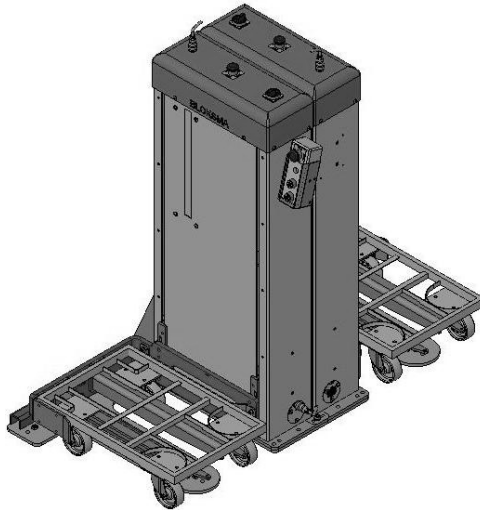
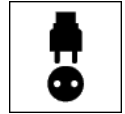

Item no. 142609

Suitable for Bloksma trolley
BOF + BOZ (see chapter TROLLEYS)

Designed for ergonomic working at assembly
work stations and machines

Standard control element
Hand lever on device
(Options see Overview CONTROL ELEMENTS)

Options:
automatic height adjustment,
trolley load control etc.

Item no.	Load capacity per lifter	Size of trolley mm	Adaption of trolley / control element	Working height above floor level (GOK)
142609	200 kg each side	600 x 400 630 x 430	lengthside BOF + BOZ stationary hand level on device	920 mm
145147	300 kg each side	600 x 400 630 x 430	lengthside BOF + BOZ stationary hand level on device	920 mm

Power demand: Pneumatic 6 bar

Other models / dimensions / loads as well as control elements on request.

The appearance of the device may deviate from the plotted models.